

# 05 GOLA HANDLELESS RAIL SYSTEM

# 05

## PRICING

Stocked Base and Wall Profiles	144
Stocked Larder Profiles	145
Bespoke Painted Base and Wall Profiles	146
Bespoke Larder Profiles	147

## TECHNICAL & INSTALLATION GUIDE

Top Rail	148
Mid Rail	152
Larder Rail	156
Appliance Filler	159
Wall Rail	160
Matrix	161

# GOLA

## Stocked Base & Wall Profiles

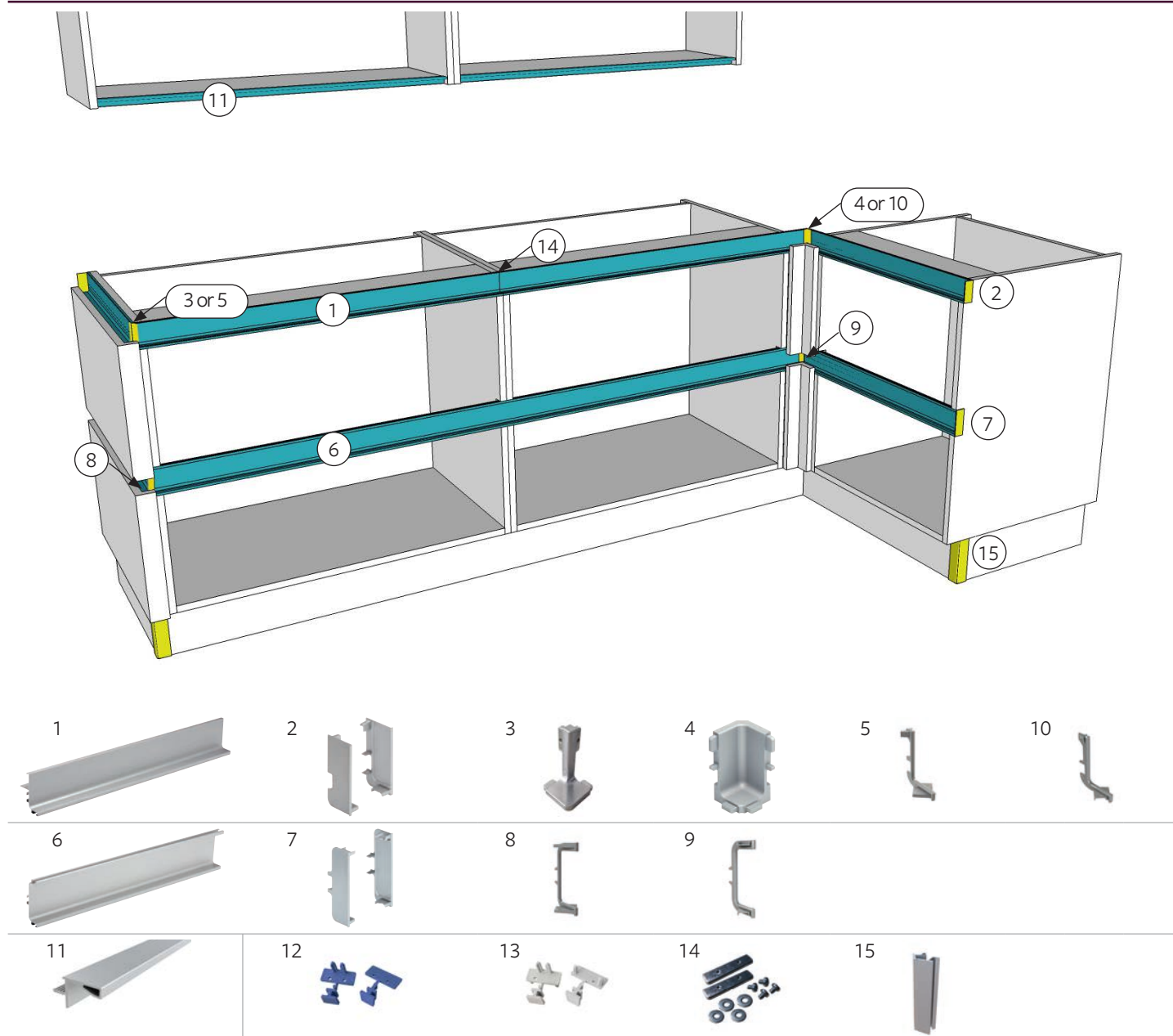

No.	Code	Type	Description	Steel (S)	Black (MB)	Page
1	GPTHP(X)	Top rail	4200mm rail			134
2	GPTINTC(X)	Top rail	End caps (1 x LH & 1 x RH)			135
3	GPTTEXT90(X)	Top rail	90° external corner connector - Metal			135
4	GPTINT90(X)	Top rail	90° internal corner connector - Metal			135
5	GPTTEXT90B(X)	Top rail	90° external corner connector - Plastic			135
10	GPTINT90B(X)	Top rail	90° internal corner connector - Plastic			135
6	GPMHP(X)	Mid rail	4200mm rail			138
7	GPMINTC(X)	Mid rail	End caps (1 x LH & 1 x RH)			139
8	GPMEXT90B(X)	Mid rail	90° external corner connector - Plastic			139
9	GPMINT90B(X)	Mid rail	90° internal corner connector - Plastic			139
11	GPWHP(X)	Wall rail	4200mm rail			146
12	GPFIX3	Fixings	Brackets - Screwed. Pack of 10			N/A
13	GPFIX2	Fixings	Brackets - Dowelled. Pack of 10			N/A
14	GPINLINE	Fixings	In-line fixing connector			N/A
15	90DCC	Fixings	Plinth connector			N/A

Please note, items 12-15 are not colour matched to the Gola profiles.

# GOLA

## Stocked Larder Profiles

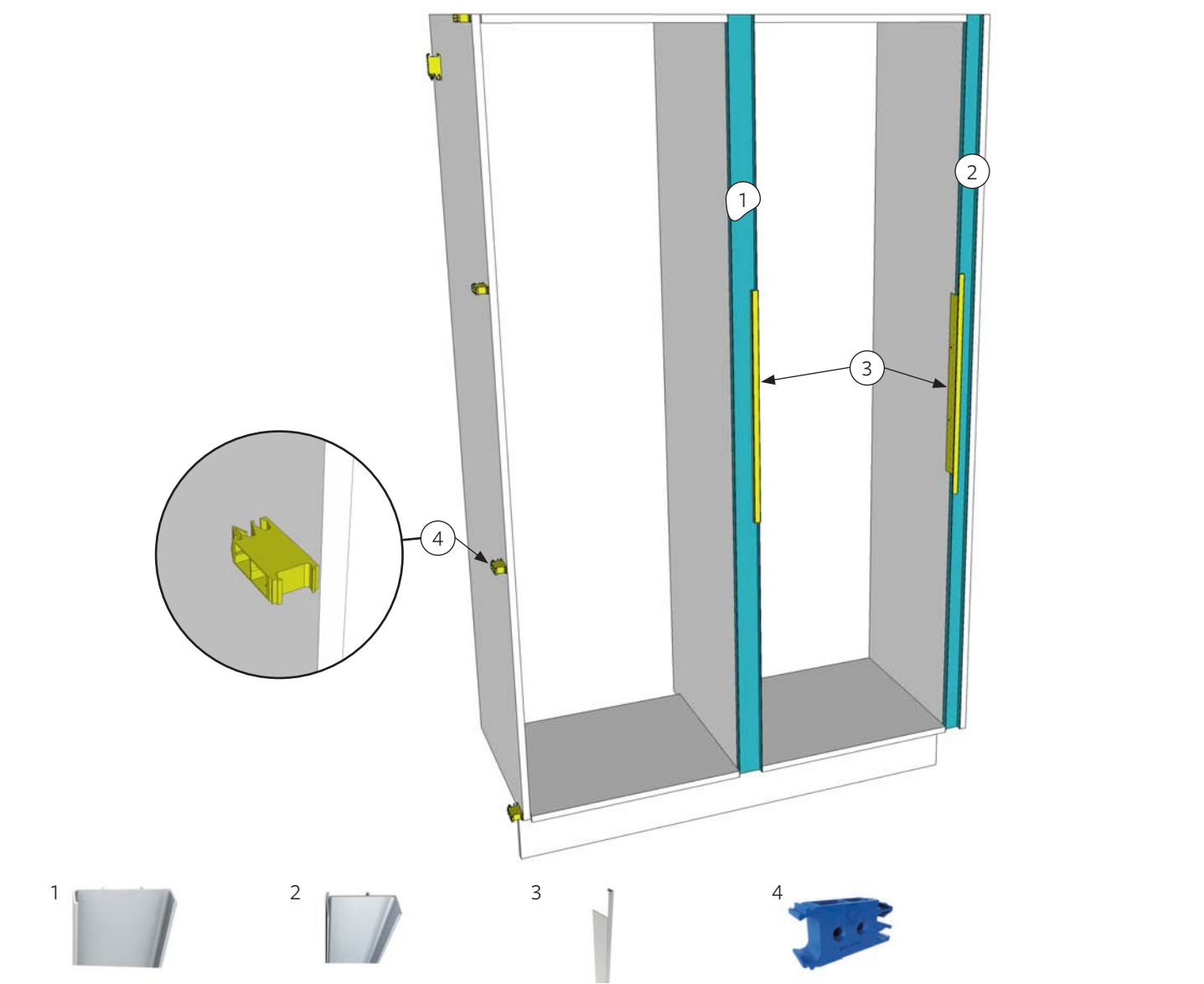

No.	Code	Type	Description	Steel (S)	Black (MB)	Page
1	GPC2(X)	Vertical rail	4200mm double rail*			142
1	GPC2.1970(X)	Vertical rail	1970mm double rail (measure 2005mm)*			142
1	GPC2.2150(X)	Vertical rail	2150mm double rail (measure 2180mm)*			142
2	GPC1(X)	Vertical rail	4200mm single rail*			142
2	GPC1.1970(X)	Vertical rail	1970mm single rail (measure 2005mm)*			142
2	GPC1.2150(X)	Vertical rail	2150mm single rail (measure 2180mm)*			142
3	GPCFILL600(X)	Filler	Appliance filler - 600 (586mm) - Single piece			143
3	GPCFILL460(X)	Filler	Appliance filler - 460 (452mm) - Single piece			143
4	GPCFIX	Fixing	Fixing plates (30 x 64 x 16) - Pack of 10			N/A

\*Vertical rails are supplied with a fixing block. See page 144 for instructions.

Code	Description	Steel (S)	Black (MB)	Page
GPTHSAMP(X)	Top rail sample			-
GPMHSAMP(X)	Mid rail sample			-

**NOTE**

To specify the colour when ordering, please use the suffix listed within the colour in the headings above.

# GOLA

## Bespoke Painted Base & Wall Profiles

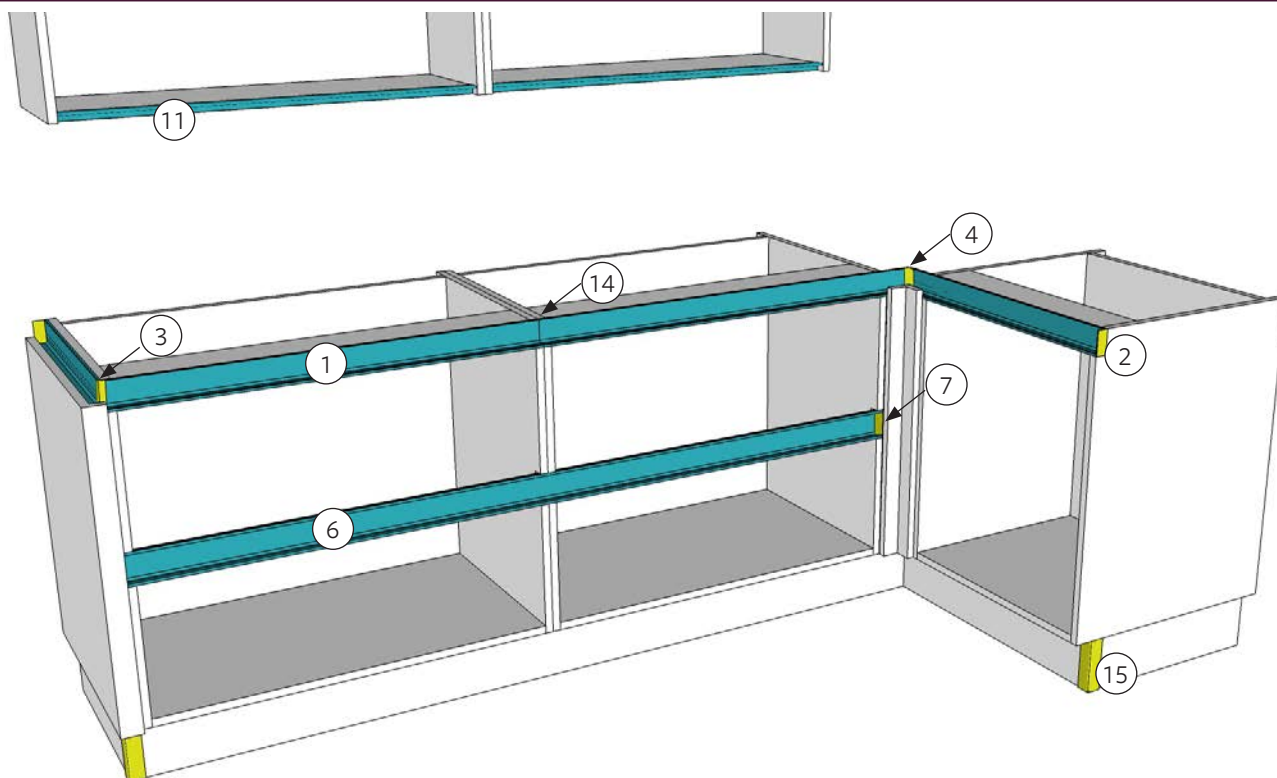

No.	Code	Type	Description	Bespoke (BE)	Shimmering (SM)	Page
1	GPTHP(X)	Top rail	3000mm rail			134
2	GPTINTC(X)	Top rail	End caps (1 x LH & 1 x RH)			135
3	GPTTEXT90(X)	Top rail	90° external corner connector - Metal			135
4	GPTINT90(X)	Top rail	90° internal corner connector - Metal			135
5	GPTTEXT90B(X)	Top rail	90° external corner connector - Plastic			135
10	GPTINT90B(X)	Top rail	90° internal corner connector - Plastic			135
6	GPMHP(X)	Mid rail	3000mm rail			138
7	GPMINTC(X)	Mid rail	End caps (1 x LH & 1 x RH)			139
8	GPMEXT90B(X)	Mid rail	90° external corner connector - Plastic			139
9	GPMINT90B(X)	Mid rail	90° internal corner connector - Plastic			139
11	GPWHP(X)	Wall rail	3000mm rail			146
12	GPFIX3	Fixings	Brackets - Screwed. Pack of 10			N/A
13	GPFIX2	Fixings	Brackets - Dowelled. Pack of 10			N/A
14	GPINLINE	Fixings	In-line fixing connector			N/A
15	90DCC	Fixings	Plinth connector			N/A

Please note, items 12-15 are not colour matched to the Gola profiles.

# GOLA

## Bespoke Larder Profiles

### Did you know?

Gola rails can be painted to any matt colour outside of our bespoke colour palette at no additional charge. This includes colours from well established paint companys.

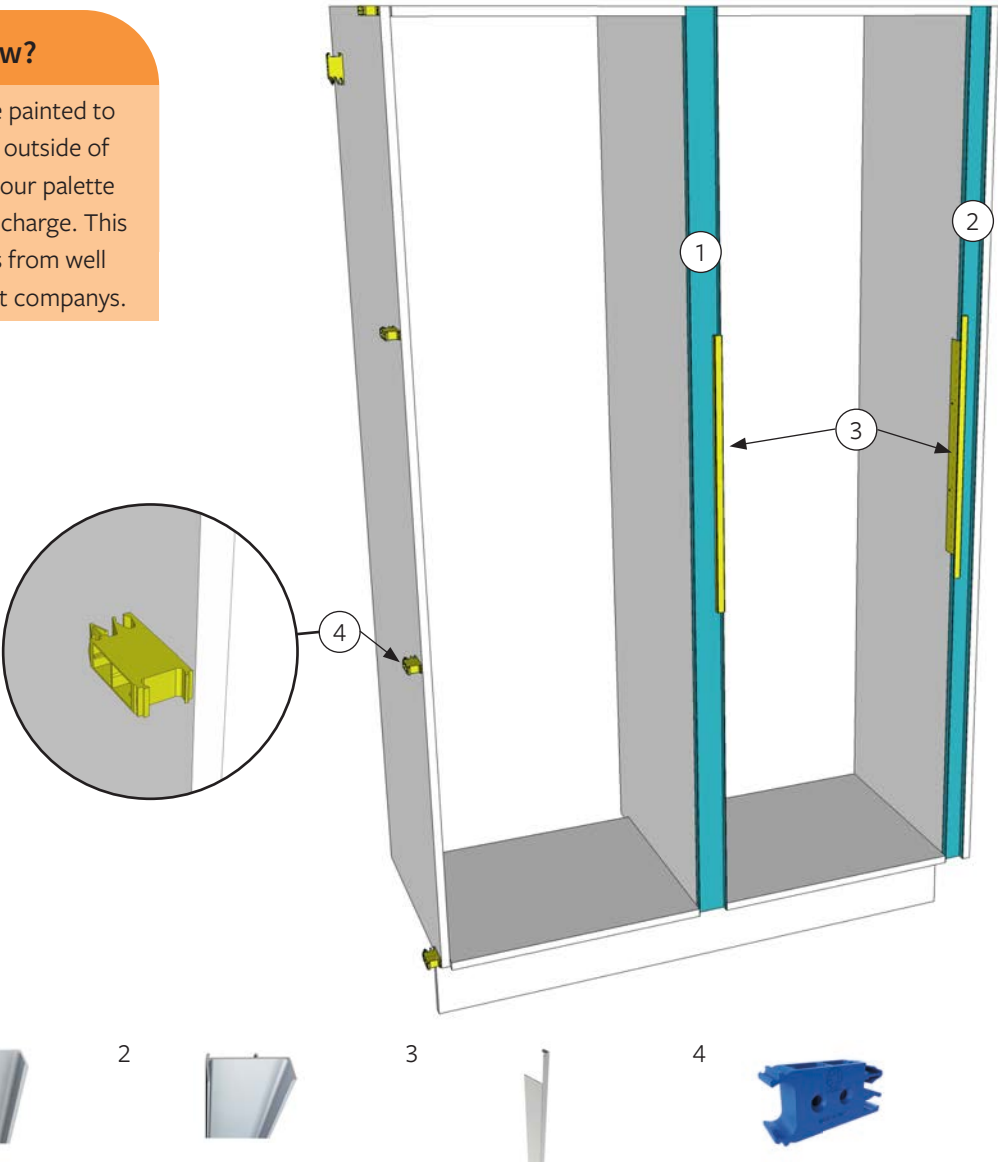

No.	Code	Type	Description	Bespoke (BE)	Shimmering (SM)	Page
1	GPC2(X)	Vertical rail	3000mm double rail*			142
1	GPC2.1970(X)	Vertical rail	1970mm double rail (measure 2005mm)*			142
1	GPC2.2150(X)	Vertical rail	2150mm double rail (measure 2180mm)*			142
2	GPC1(X)	Vertical rail	3000mm single rail*			142
2	GPC1.1970(X)	Vertical rail	1970mm single rail (measure 2005mm)*			142
2	GPC1.2150(X)	Vertical rail	2150mm single rail (measure 2180mm)*			142
3	GPCFILL600(X)	Filler	Appliance filler - 600 (586mm) - Single piece			143
3	GPCFILL460(X)	Filler	Appliance filler - 460 (452mm) - Single piece			143
4	GPCFIX	Fixing	Fixing plates (30 x 64 x 16) - Pack of 10			N/A

\*Vertical rails are supplied with a fixing block. See page 144 for instructions.

Code	Description	Bespoke (BE)	Shimmering (SM)	Page
GPTHSAMP(X)	Top rail sample			-
GPMHSAMP(X)	Mid rail sample			-

### NOTE

To specify the colour when ordering, please use the suffix listed within the colour in the headings above.

# GOLA

## Top Rail

### TOP RAIL OVERVIEW

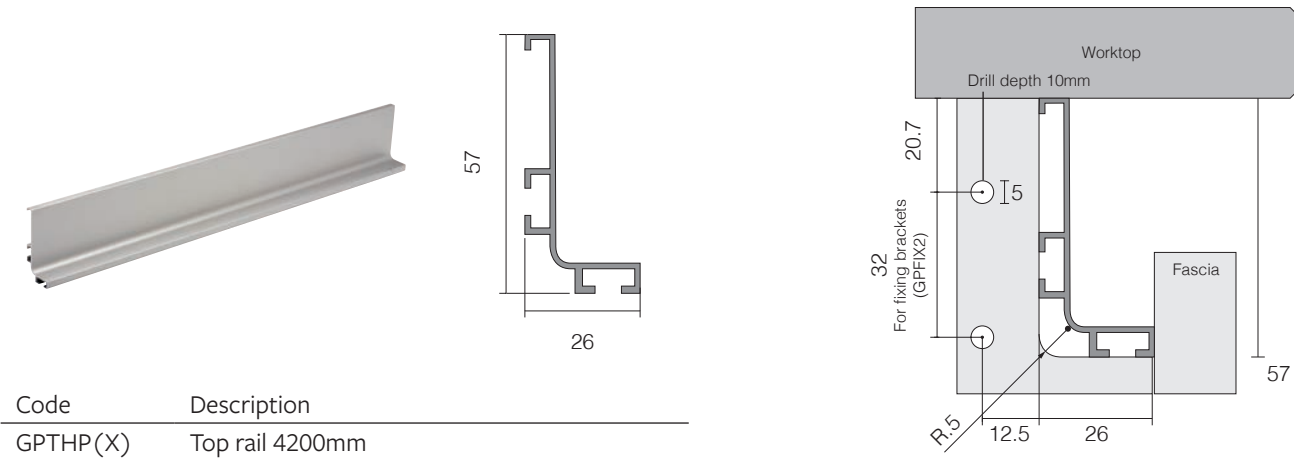

- This product is for **base** units.
- Secured to cabinets with fixing brackets.  
Code: GPFIX2 or GPFIX3.
- Can be cut to size with a circular chop saw.

(X) Suffix required to specify colour

### CABINET DIMENSIONS

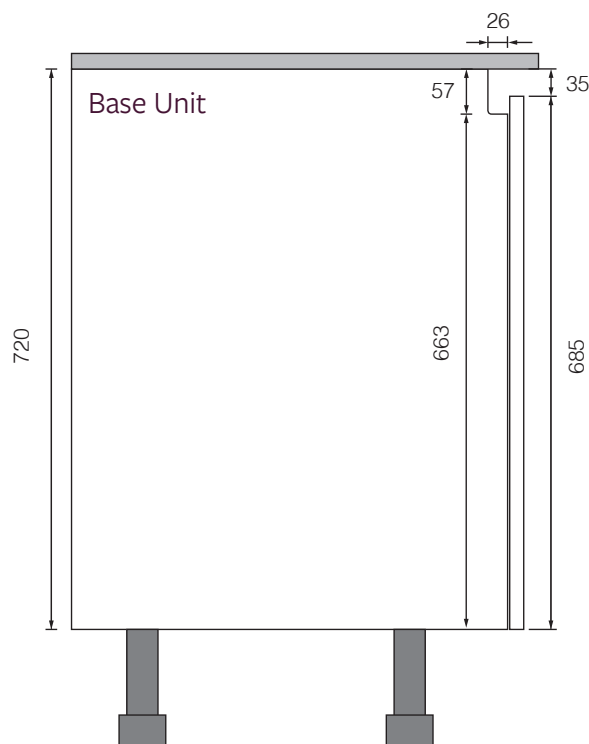

# GOLA

## Top Rail Accessories

### INTERNAL CORNER CONNECTORS

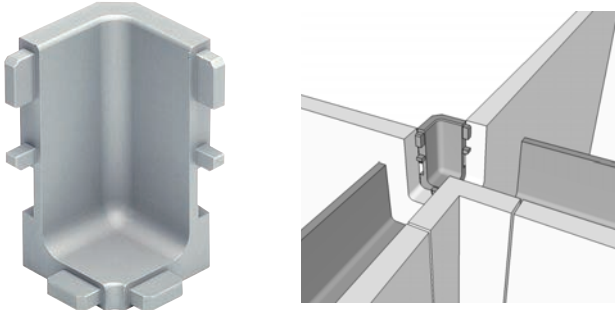

Code	Description
GPTINT90(X)	90° internal corner connector - metal
<b>Note:</b> This product is to be used with the internal corner post Rails to be cut square.	

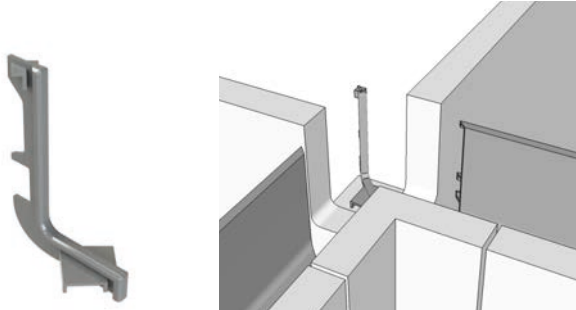

Code	Description
GPTINT90B(X)	90° internal corner connector - plastic
<b>Note:</b> This product is to be used with the internal corner post. Rails to be cut on 45° angle.	

### EXTERNAL CORNER CONNECTORS

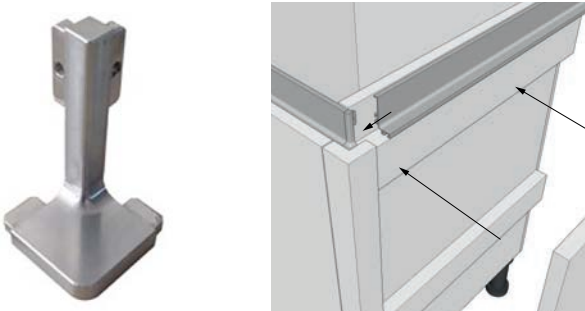

Code	Description
GPTEXT90(X)	90° external corner connector - metal
<b>Note:</b> This product is to be used with the external corner post	

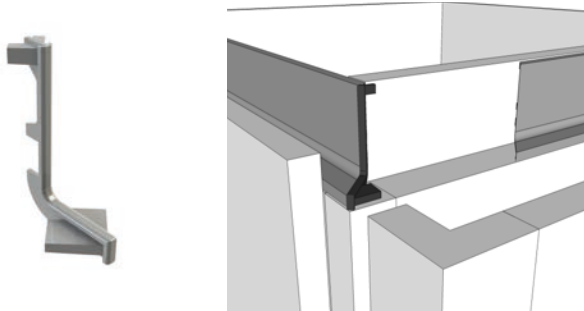

Code	Description
GPTEXT90B(X)	90° external corner connector - plastic
<b>Note:</b> This product is to be used with the external corner post	

### END CAPS

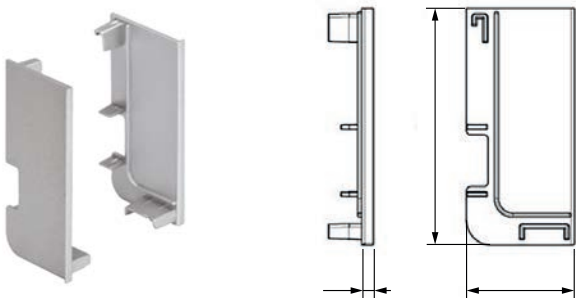

Code	Description
GPTINTC(X)	End caps - plastic
<b>Note:</b> This product is to be used to cap top gola rail profiles	

(X) Suffix required to specify colour



# GOLA

## Top Rail Installation

### TOP RAIL OVERVIEW

Step 1

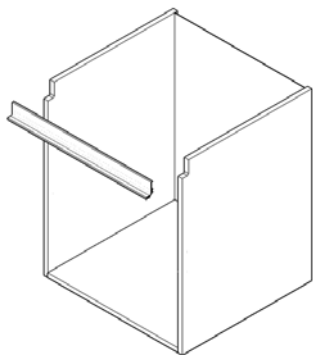

Step 2

Dowelled fixing bracket  
Code: GPFIX2

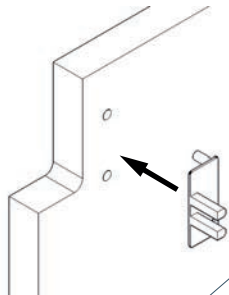

OR

Screwed fixing bracket  
Code: GPFIX3

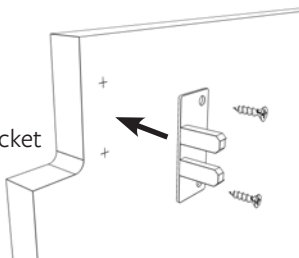

Step 3

Locking device, included  
with fixing sets

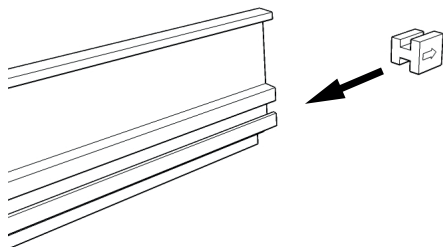

Step 4

Locking device, included  
with fixing sets

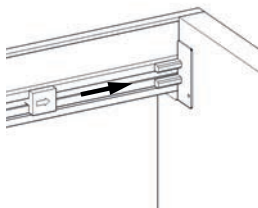

OR

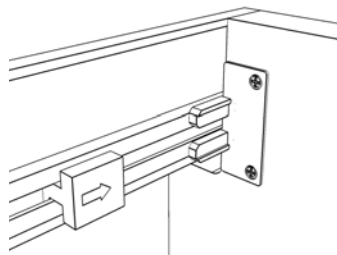

Step 5

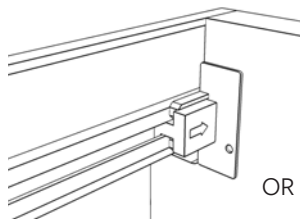

OR

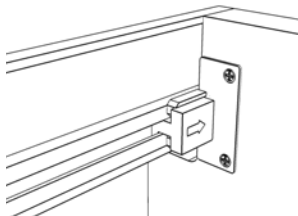

Step 6

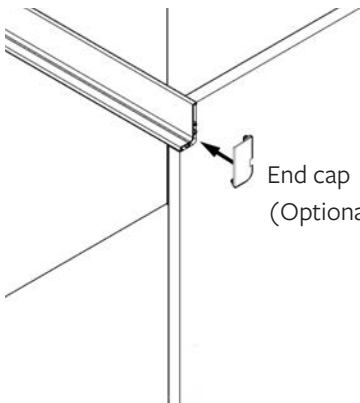

End cap  
(Optional)



### MID RAIL OVERVIEW

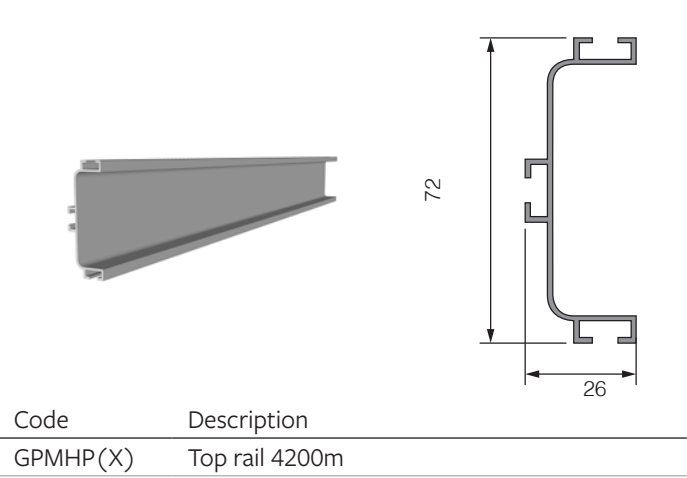

- This product is for **base** units.
- Secured to cabinets with fixing brackets.  
Code: GPFIX2 or GPFIX3.
- Can be cut to size with a circular chop saw.

(X) Suffix required to specify colour

### CABINET DIMENSIONS

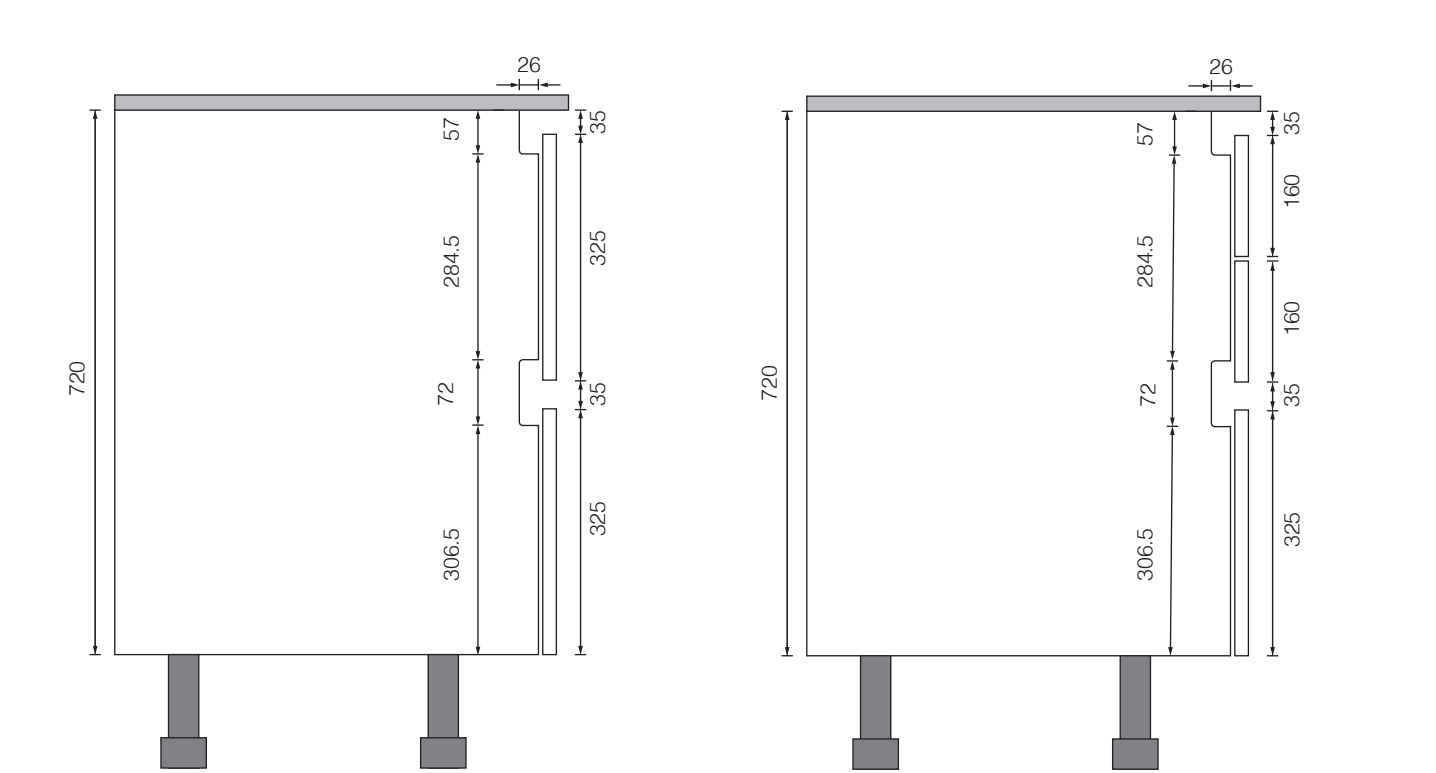

# GOLA

## Technical Information - Mid Rail Accessories

### INTERNAL CORNER CONNECTORS



Code	Description
GPMINT90B(X)	90° internal corner connector - plastic
<b>Note:</b> This product is to be used with a modified corner post	

### EXTERNAL CORNER CONNECTORS



Code	Description
GPMEXT90B(X)	90° external corner connector - plastic
<b>Note:</b> This product is to be used with a modified external corner post	

### END CAPS

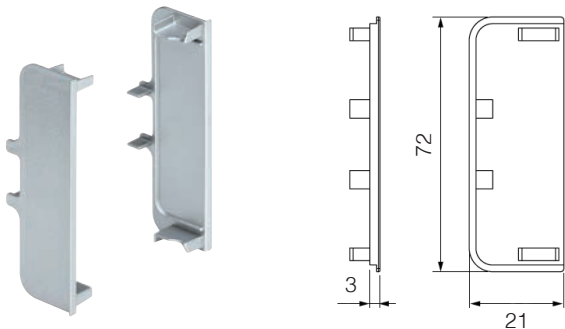

Code	Description
GPMINTC(X)	End caps - plastic
<b>Note:</b> This product is to be used to cap gola rail profiles	

(X) Suffix required to specify colour

# GOLA

## Mid Rail Installation

### TOP RAIL OVERVIEW

Step 1

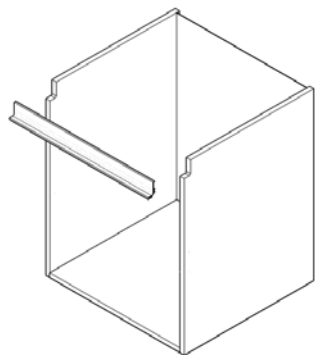

Step 2

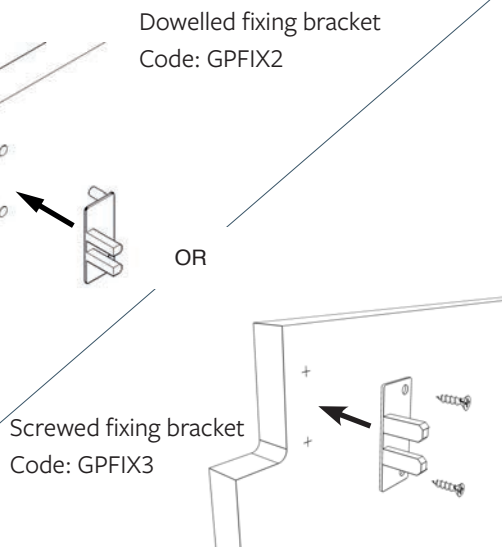

Step 3

Locking device, included  
with fixing sets

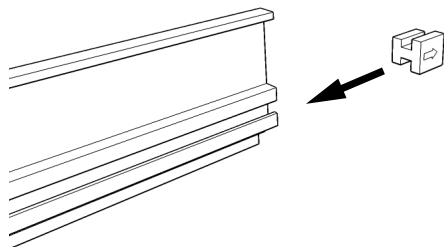

Step 4

Locking device, included  
with fixing sets

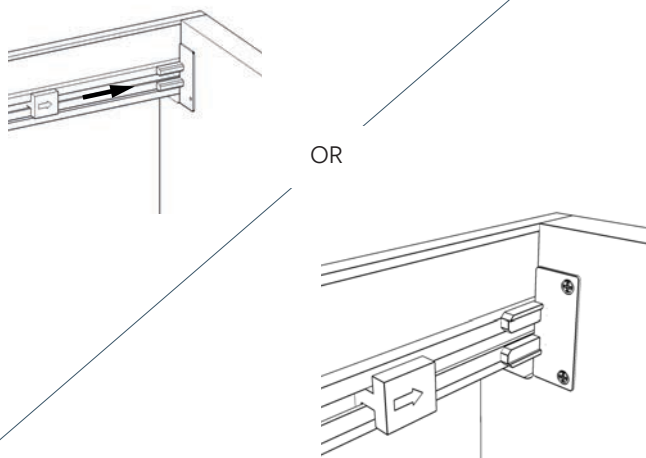

Step 5

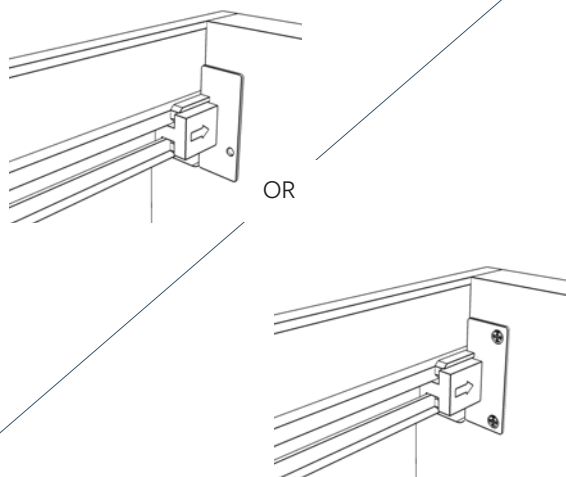

Step 6

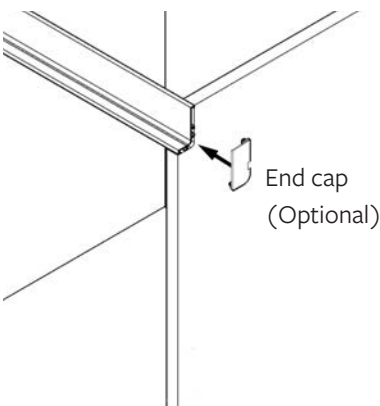



# GOLA

## Larder Rail

### VERITCAL RAIL OVERVIEW

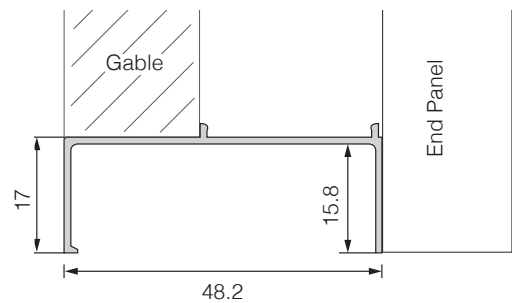

Code	Description
GPC1(X)	Vertical rail - single, 4200mm
GPC1.1970(X)	Vertical rail - single, 1970mm
GPC1.2150(X)	Vertical rail - single, 2150mm

- This product is for **tall units**.
- Secured to cabinets with fixing brackets.  
Code: GPCFIX
- Cabinet gables must be reduced by **17mm**.
- Can be cut to size with a circular chop saw.

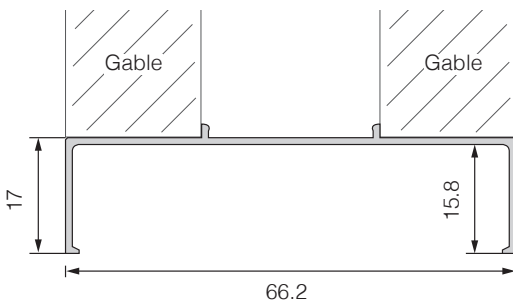

Code	Description
GPC2(X)	Vertical rail - double, 4200mm
GPC2.1970(X)	Vertical rail - double, 1970mm
GPC2.2150(X)	Vertical rail - double, 2150mm

- This product is for **tall unit**.
- Secured to cabinets with fixing brackets.  
Code: GPCFIX
- Cabinet gables must be reduced by **17mm**.
- Can be cut to size with a circular chop saw.

(X) Suffix required to specify colour

# GOLA

Appliance Fillers

APPLIANCE FILLER PROFILE

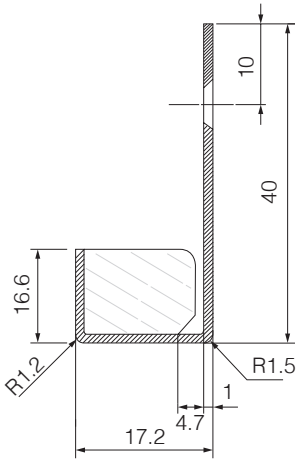

APPLIANCE FILLER - 600

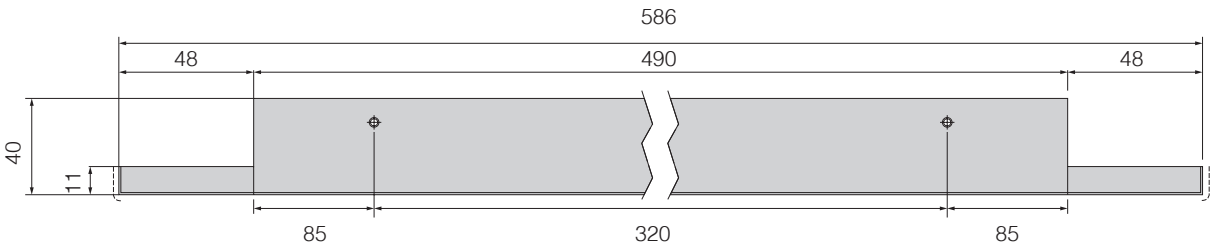

APPLIANCE FILLER - 460

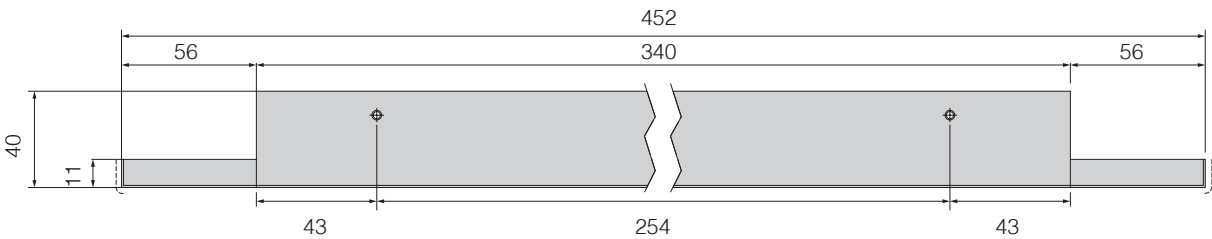



# GOLA

## Larder Rails Installation

1) Attach 4 fixing plate to the front of the cabinet side gable (see specific measurements below). Position one fixing plate towards the back to assist with spacing.

2) Secure the units by positioning the MDF fixing block (supplied with each vertical rail) behind the fixing plate and screw the cabinets together. This allows you to secure the cabinets together.



### DOUBLE VERTICAL RAIL FIXING POSITIONS

See right for further instructions

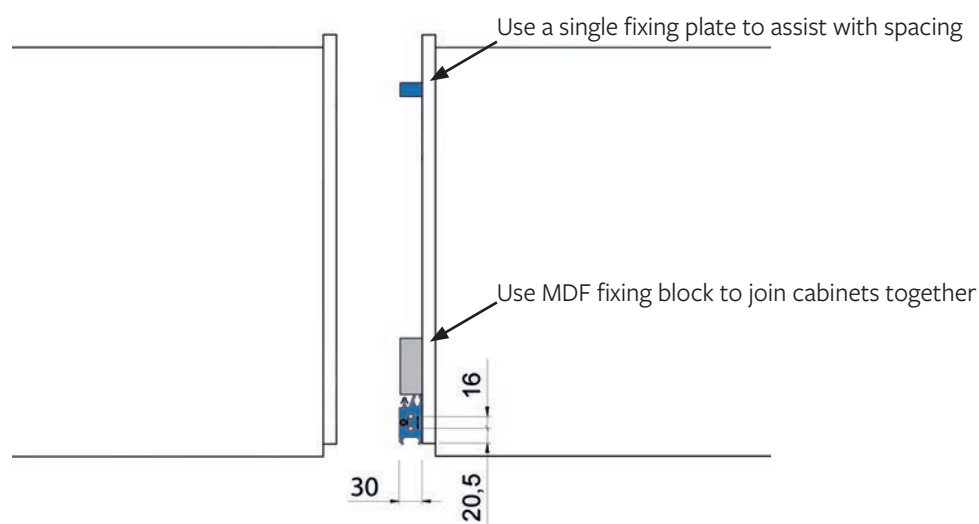

### SINGLE VERTICAL RAIL FIXING POSITIONS

See right over for further instructions

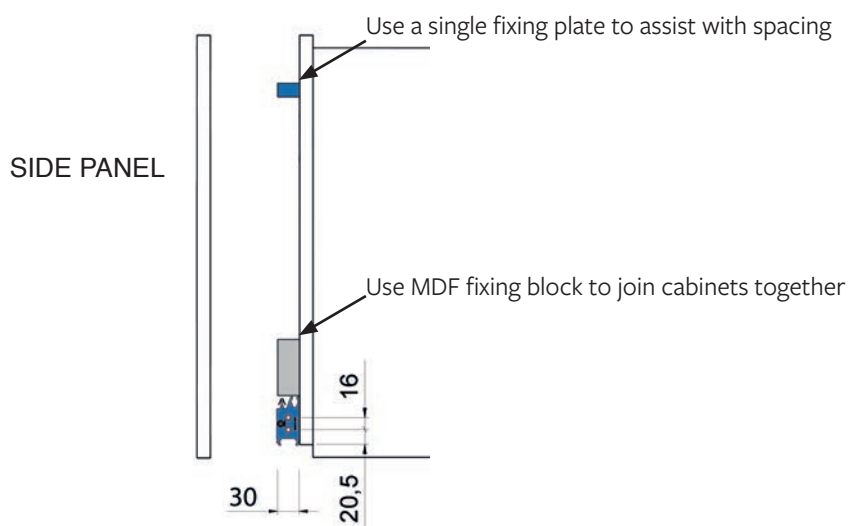

# GOLA

## Appliance Filler

Single Vertical Rail

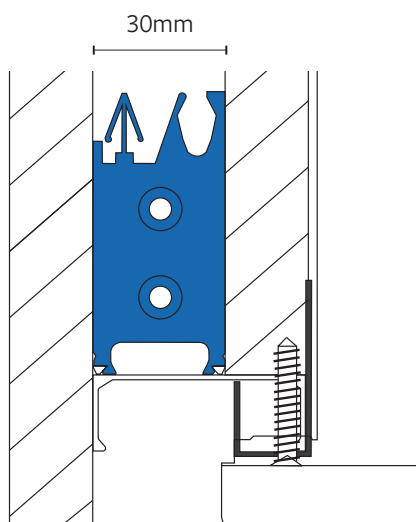

Double Vertical Rail

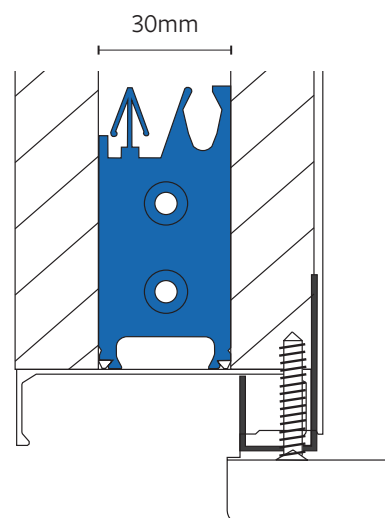

- This product is for **appliances**
- Available for 460 and 600mm high appliances

Step 1

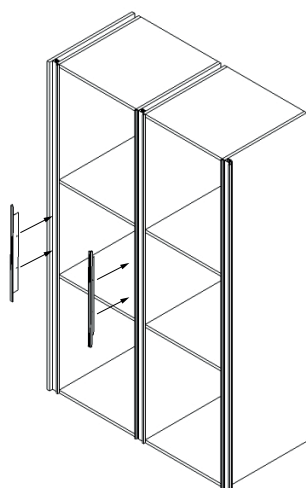

Step 2

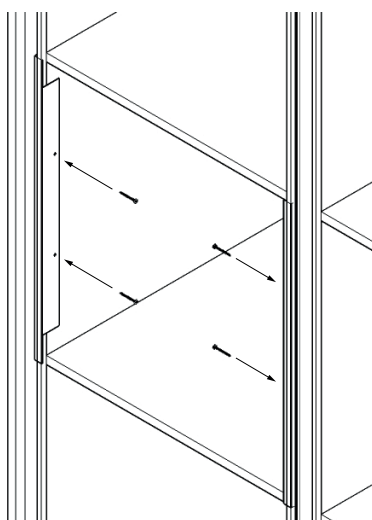

Step 3

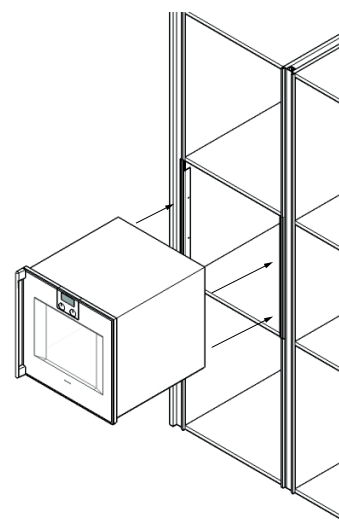

### Double Oven Install

For double oven installations 2 x 460 fillers are required. This creates a slight overhang, but it is not noticeable.

# GOLA

## Wall Rail

### MID RAIL OVERVIEW

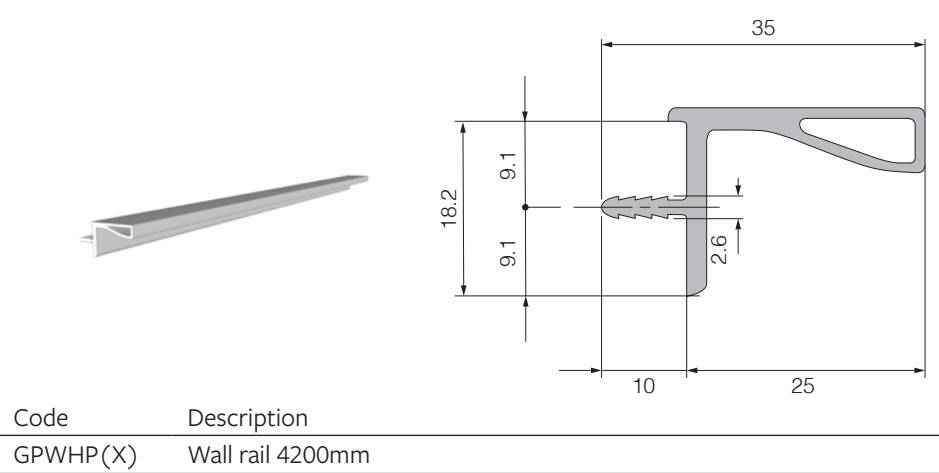

- This product is for **wall** units.
- The base shelf of the wall cabinet requires a routed section to accommodate the rail.
- Can be cut to size with a circular chop saw.

(X) Suffix required to specify colour

### CABINET DIMENSIONS

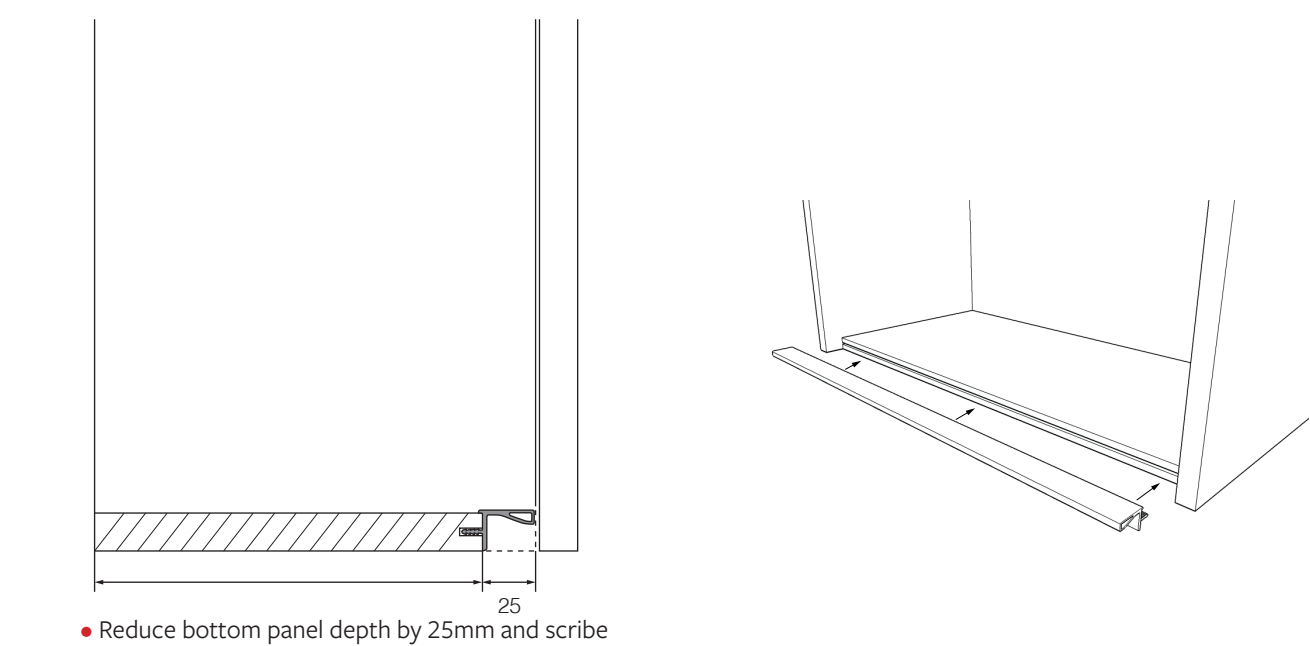

# GOLA

## Matrix

